

PRODUCT SPECIFICATION SHEET



Rev. C1

UFO 11D Downlight



An adjustable recessed downlight fitting, secured through ceiling with spring clips.

Available in a range of finishes, this fitting can be rotated and tilted to point directly at any objects to be illuminated. The fitting also allows for the light beam to be focused. The fitting is also suitable for mounting in the base of a display case and illuminating upwards.

Our downlight fittings are suitable for use in a variety of different applications and are the ideal solution for the illumination of static objects within a display case or cabinet.

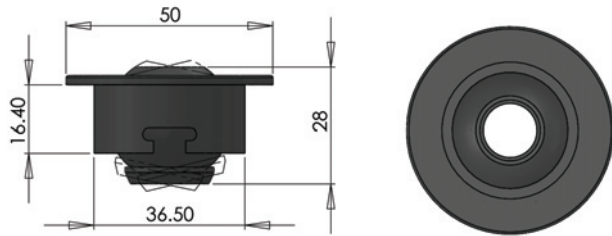

TECHNICAL INFORMATION

Lens	18mm lens
Focus range	30° - 50°
Material	Aluminium, stainless steel or polycarbonate/ABS
Finishes available	Aluminium, stainless steel, chrome, black, white
Flange size	ø50
Tilt	20°
Rotation	360°
Weight	47.1g (aluminium) 21.9g (polycarbonate)
Mounting hole size	40mm
Mounting	Recessed, held by springs
Ferrule size	M10 or 8mm smooth
Min. fibre size	2mm
Max. fibre size	8mm

ORDERING CODES

MODEL	MATERIAL		FINISH		FERRULE SIZE	
UFO 11D	Aluminium	ALU	Aluminium	ALU	M10	M10
	Stainless Steel	SS	Stainless Steel	SS	8mm	8mm
	Polycarbonate	PC	Chrome	CH		
			Black	BL		
			White	WH		
UFO 11D						